

3 - Bedroom

Type B1

88 sq m / 947 sq ft

#02-06 to #11-06, #12-06 (High Ceiling)

#02-14 to #11-14, #12-14 (High Ceiling)

#02-20 to #11-20, #12-20 (High Ceiling) *

#02-40 to #11-40, #12-40 (High Ceiling)

#02-41 to #11-41, #12-41 (High Ceiling)

Type B1a

88 sq m / 947 sq ft

#01-06

#01-14

#01-20 *

#01-40

screen for units

#03-06, #06-06, #09-06, #12-06,

#03-14, #06-14, #09-14, #12-14,

#01-20, #04-20, #07-20, #10-20, #12-20,

#03-40, #06-40, #09-40, #12-40,

#03-41, #06-41, #09-41, #12-41.

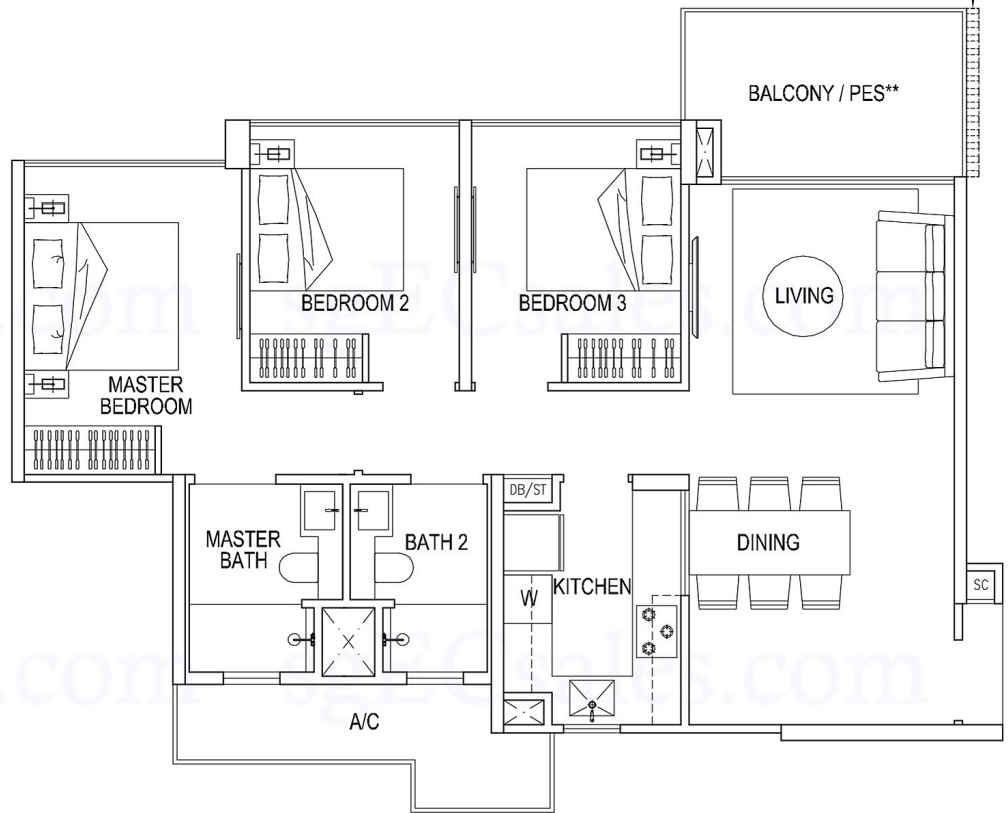

Type B1a (Partial plan)

88 sq m / 947 sq ft

#01-41

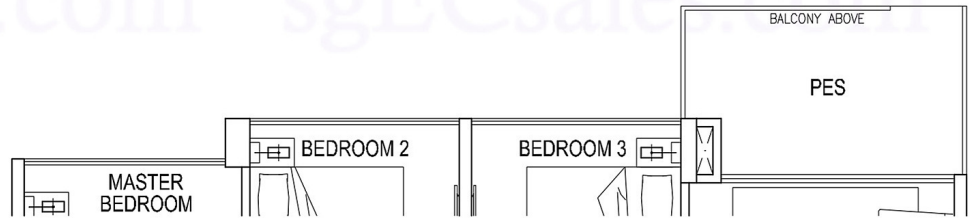

* mirror – image

**1st storey units PES
in lieu of Balcony

Area includes A/C ledge, balcony and PES where applicable. Orientations and facings will differ depending on the unit you are purchasing. Please refer to the key plan. The plans are subjected to change as may be required or approved by relevant authorities. All areas are approximate and subject to final survey. The developer and its agents cannot be held liable for any inaccuracies.

